

John Pawson by COCOON

JP-01-EXT

TECHNICAL WARNINGS

The pipes have to be rinsed thoroughly before installation to avoid pressure differences.

Use of a pressure reducer when static pressure is higher than 5 bar to avoid damage to the cartridge.

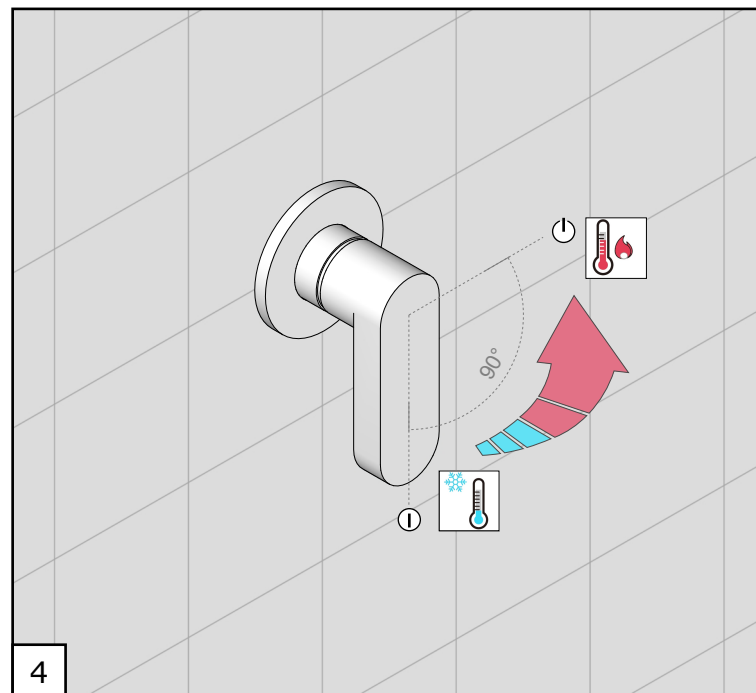
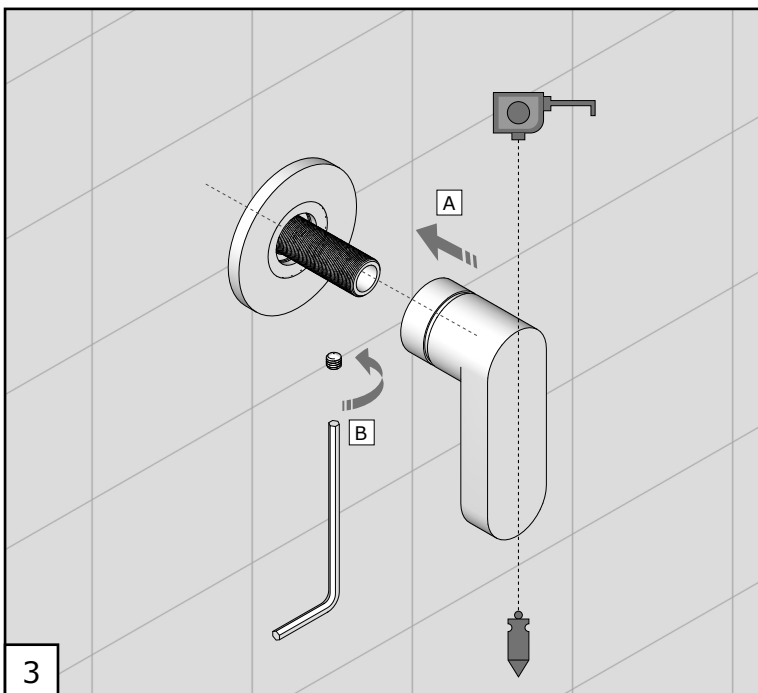
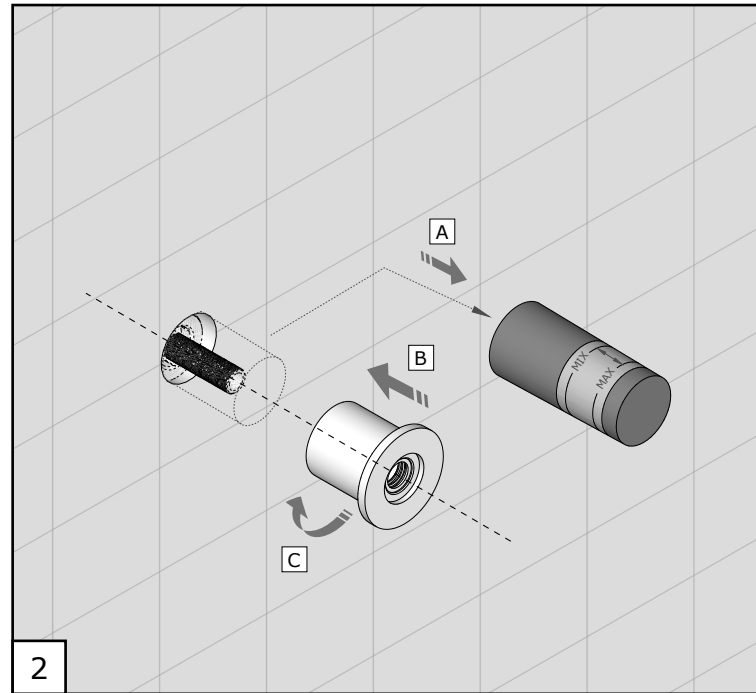
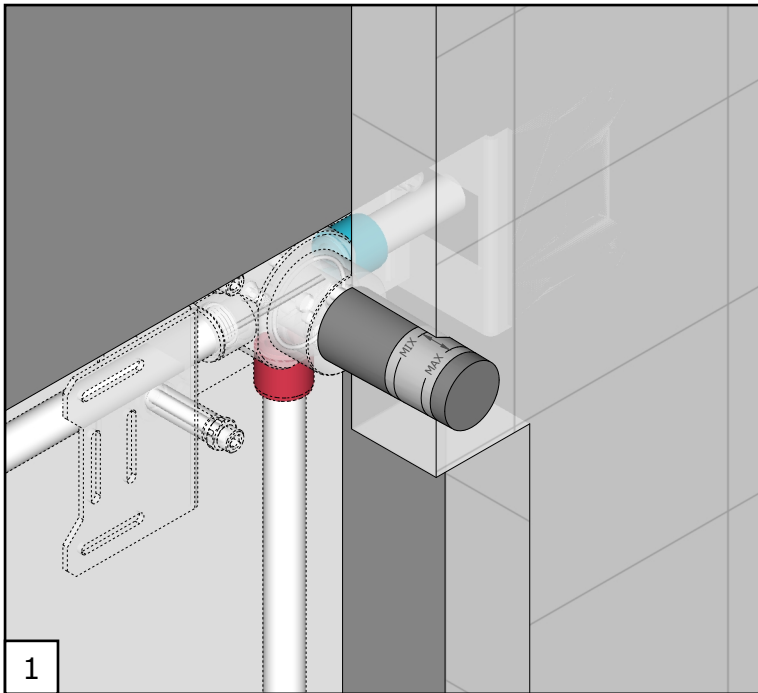

John Pawson by COCOON

JP-10.0 projection 200mm

JP-10.1 projection 275mm

JP-10.2 projection 350mm

TECHNICAL WARNINGS

The pipes have to be rinsed thoroughly before installation to avoid pressure differences.

TEMPERATURA DI ESERCIZIO / WORKING TEMPERATURE

 max. 70 °C
max. 158 °F

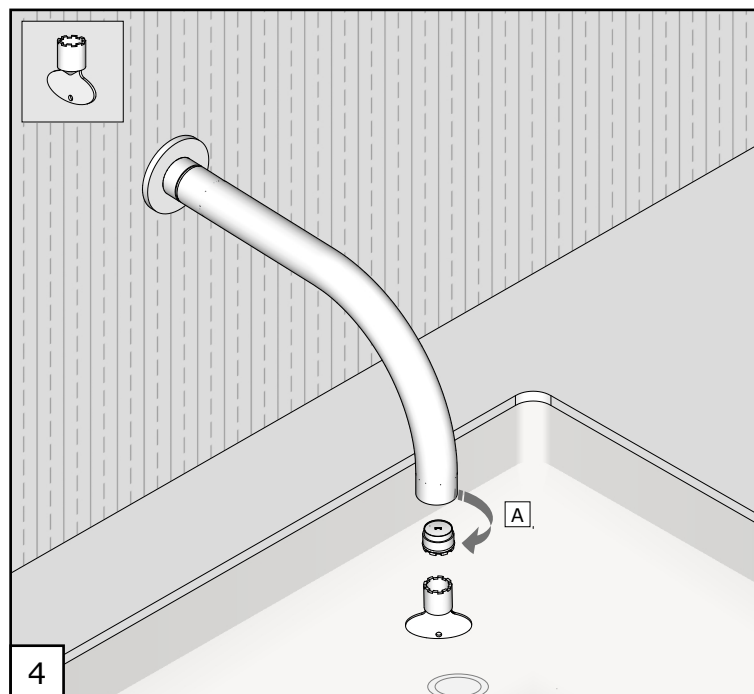
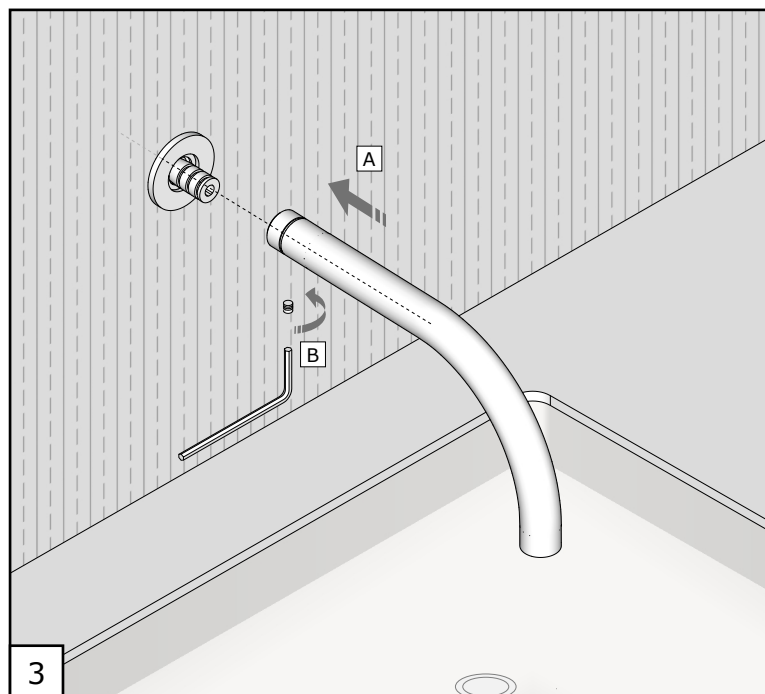
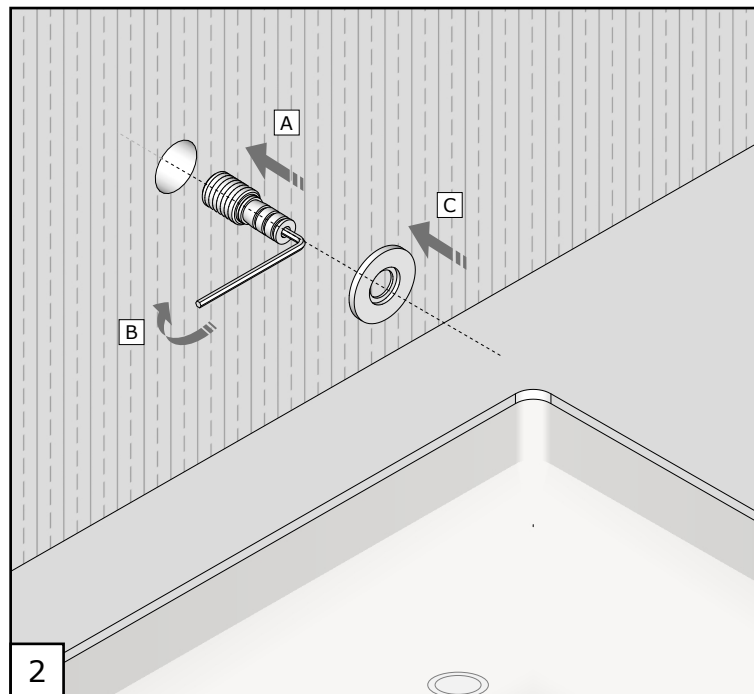
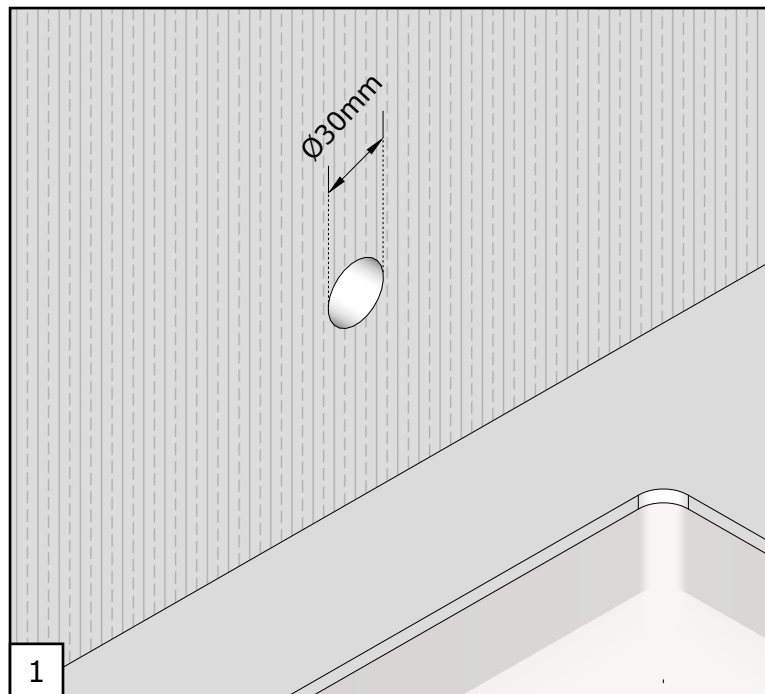

Le portate indicate sono alla pressione consigliata di 3 bar
The indicated flow rates are at the recommended pressure of 3 bar

AERATORE IN DOTAZIONE / AERATOR INCLUDED

 Aeratore montato / Mounted aerator
5 l/min / 1.3 gpm